

CONSTRUCTION NOTES:

- 21 INSTALL BROOKS BASIN 24-24 (OR EQUAL) W/TRAFFIC RATED GRATE
- 22 INSTALL 4" DRAIN PIPE AT 0.5% MIN.
- 23 INSTALL 3" DRAIN PIPE AT 0.5% MIN.
- 24 INSTALL 3" x 12" CAST IRON RECTANGULAR PIPE/PARKWAY CULVERT PER MODIFIED CITY OF SAN BERNARDINO DEPT. OF PUBLIC WORKS, STANDARD PLAN NO. 401
- 25 CONSTRUCT CURB FACE OUTLET FOR 3" X 12" CAST IRON PARKWAY DRAIN PER MODIFIED CITY OF SAN BERNARDINO DEPARTMENT OF PUBLIC WORKS STD. PLAN 401
- 26 INSTALL 12" NDS CATCH BASIN (OR EQUAL)
- 27 INSTALL 18" NDS CATCH BASIN (OR EQUAL)
- 28 INSTALL GRAVEL FILLED INFILTRATION TRENCH (L=20', W=5', D=3') 105 CU.FT. STORAGE
- 29 INSTALL 4" PERFORATED DRAIN PIPE AT 0.5% MIN. THROUGH LENGTH OF INFILTRATION TRENCH
- 30 INSTALL IMPERMEABLE LINER ON WEST SIDEWALL OF INFILTRATION TRENCH

E 1800035
LD 1800005

Underground Service Alert

Call: TOLL FREE
1-800
422-4133

TWO WORKING DAYS BEFORE YOU DIG

BENCHMARK:
B.M. NO. B5-6 (NAV 88)
LOCATED 82.0' SOUTH AND 33.5' WEST OF C/L
INTERSECTION OF HOLLY VISTA AVENUE AND GOLDEN
AVENUE, 5.5' SOUTH OF POWER POLE NO. 1883881E
ELEV. 1228.310

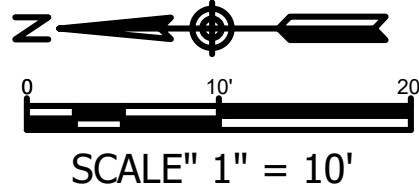

Lodging Engineering
ASSOCIATES, INC.

Civil Engineering • Surveying • Planning

100 East Third Street
San Bernardino, CA 92410
Phone: 909-894-6217
Fax: 909-894-6133

5800 Hwy. 95, Ste. B
Font Monrovia, AZ 85403
Phone: 928-768-1857
Fax: 928-768-7086

15252 Serrano Rd.
Victorville, CA 92392
Phone: 760-932-7976
Fax: 760-241-6272

2126 McCulloch Blvd., Ste. B
Lake Havasu City, AZ 86403
Phone: 928-666-6900
Fax: 928-654-8530

MARK	REVISIONS	BY	APPR.	DATE
BENCH MARK:				

APPROVED	2018
SENIOR CIVIL ENGINEER	
REGISTERED CIVIL ENGINEER NO.	
DRAWN BY:	MTD
CHECKED BY:	FJW
RECOMMENDED BY:	

CITY OF SAN BERNARDINO
DEVELOPMENT SERVICES—PUBLIC WORKS/ENGINEERING

DRAINAGE PLAN
FOR
GOLDEN APARTMENTS

CLIENT:
GOLDEN APARTMENTS SAN BERNARDINO, LP

PROJECT NO. SB-1113

FOR CITY USE ONLY: FILE NO.

DRAWING NO.
13205

SHEET 4 OF 8 SHEETS

W.O. NO.

LEGEND:

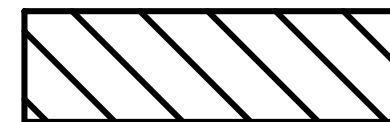

INDICATES EXISTING CONCRETE - TO BE REMOVED

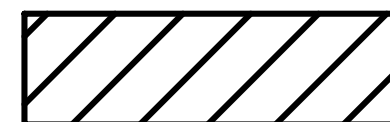

INDICATES EXISTING ASPHALT PAVEMENT - TO BE REMOVED



INDICATES EXISTING DRAINAGE PIPE - TO BE REMOVED



INDICATES EXISTING DROP INLET DRAIN - TO BE REMOVED
(AND SALVAGED FOR REUSE - IF POSSIBLE)

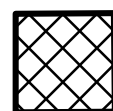

INDICATES EXISTING STORAGE ENCLOSURES - TO BE REMOVED

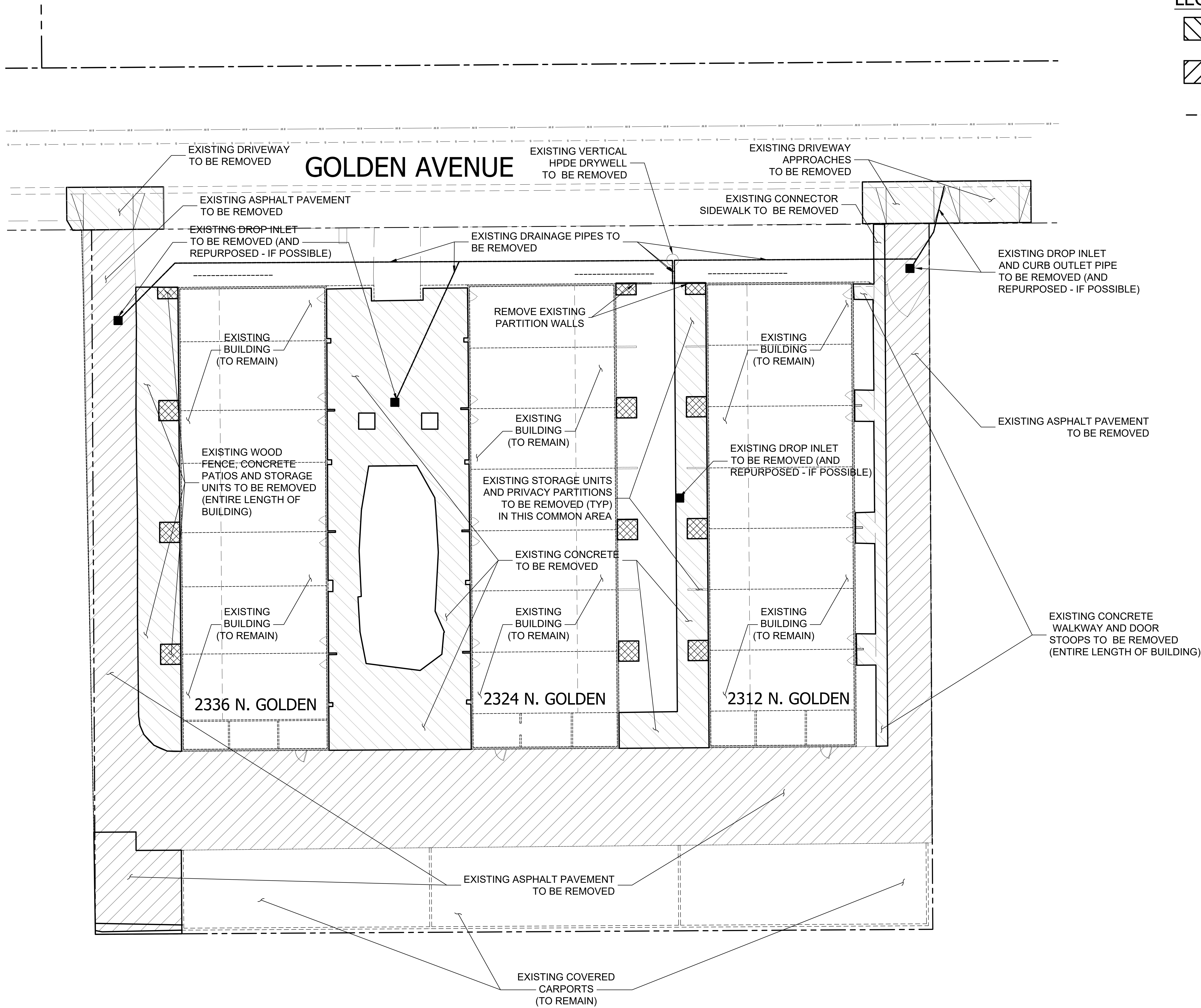

E 1800035
LD 1800005

Underground Service Alert



Call: TOLL FREE
1-800
422-4133

TWO WORKING DAYS BEFORE YOU DIG

BENCHMARK:

B.M. NO. B5-6 (NAV 88)

LOCATED 82.0' SOUTH AND 33.5' WEST OF C/L
INTERSECTION OF HOLLY VISTA AVENUE AND GOLDEN
AVENUE, 5.5' SOUTH OF POWER POLE NO. 1883881E

ELEV. 1228.310

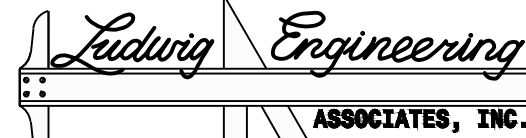
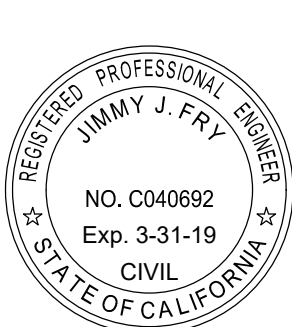
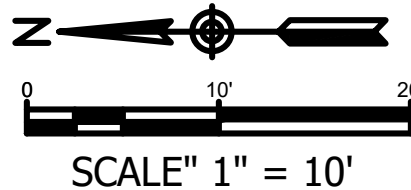

Civil Engineering • Surveying • Planning
109 East Third Street
San Bernardino, CA 92410
Phone: 909-894-6217
Fax: 909-894-6213
15252 Sierra Rd.
Victorville, CA 92392
Phone: 760-952-7976
Fax: 760-241-6272
5800 Hwy. 95, Ste. B
Font Roberts, AZ 85424
Phone: 928-768-1857
Fax: 928-768-7886
2126 McCulloch Blvd., Ste. B
Lake Havasu City, AZ 86403
Phone: 928-666-6900
Fax: 928-664-8530

MARK	REVISIONS	BY	APPR.	DATE
BENCH MARK:				

APPROVED _____ 2018

SENIOR CIVIL ENGINEER
REGISTERED CIVIL ENGINEER NO. _____

DRAWN BY: MTD

CHECKED BY: FJW

RECOMMENDED BY:

CITY OF SAN BERNARDINO
DEVELOPMENT SERVICES—PUBLIC WORKS/ENGINEERING

DEMOLITION PLAN
FOR
GOLDEN APARTMENTS

CLIENT:
GOLDEN APARTMENTS SAN BERNARDINO, LP

PROJECT NO. SB-1113

FOR CITY USE ONLY: FILE NO.

W.O. NO.

DRAWING
NO.
13205

SHEET 2 OF
8 SHEETS

PLOT DATE: June 8, 2018

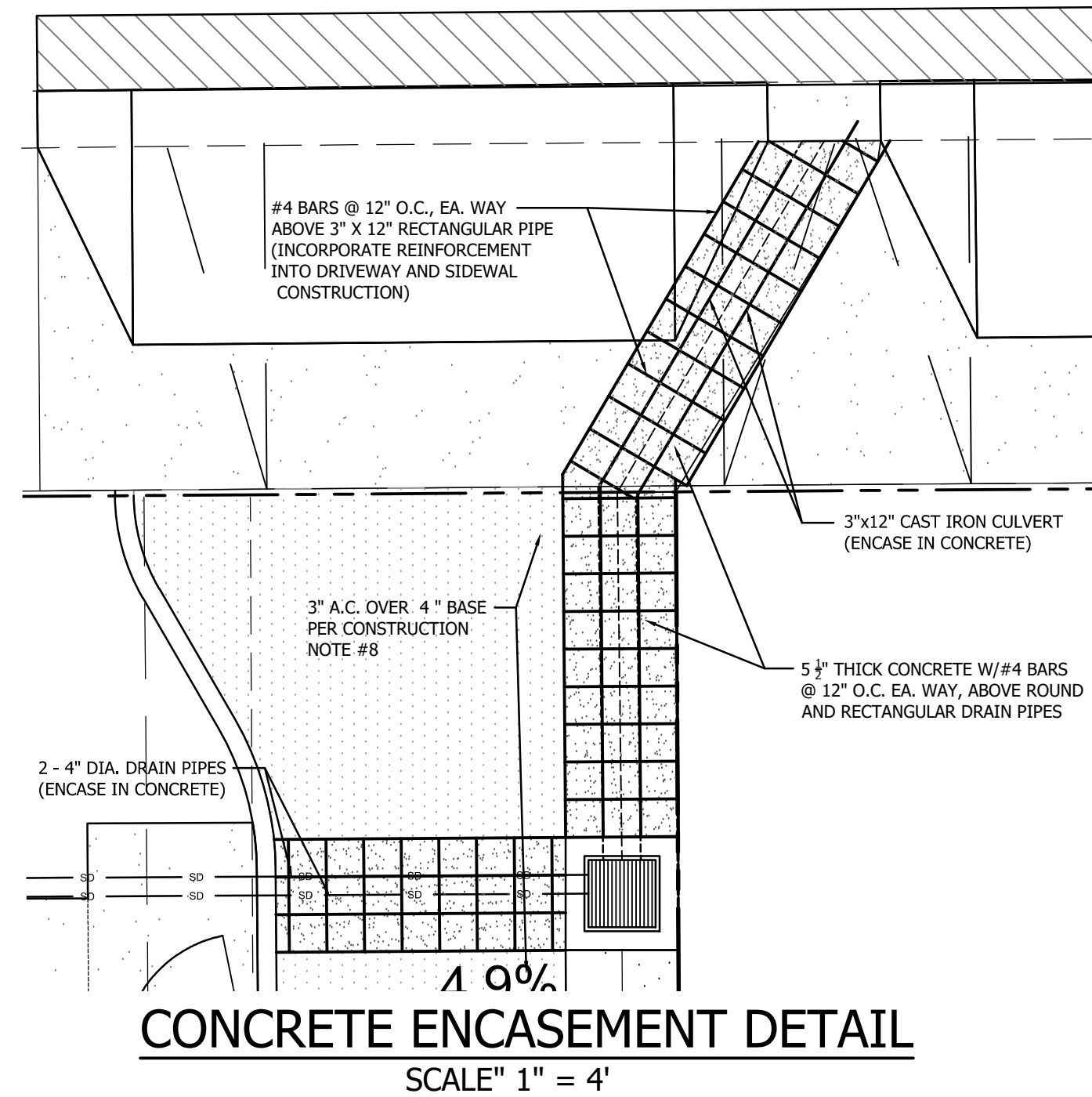
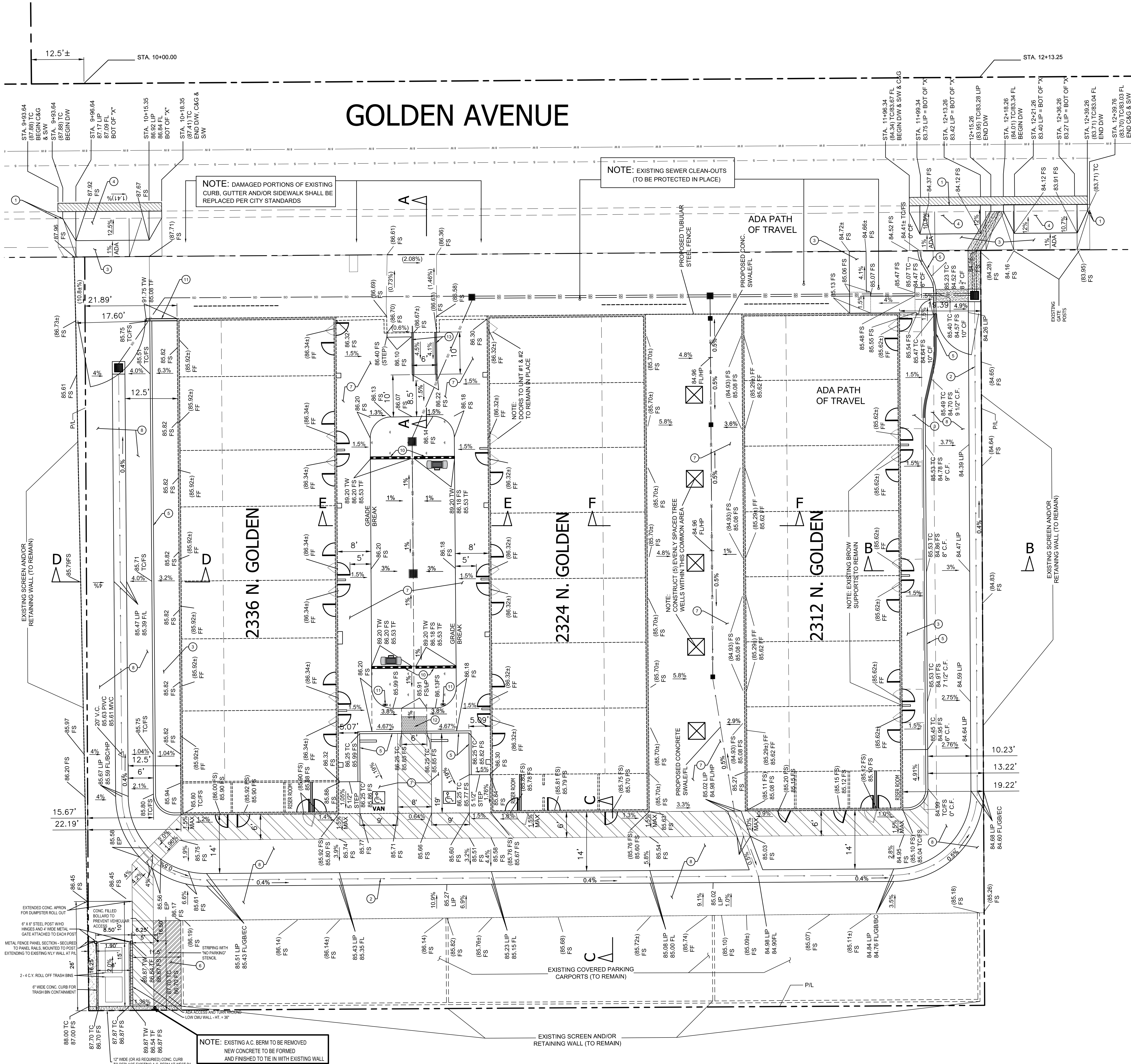

CONSTRUCTION NOTES:

1. CONSTRUCT 6" CURB & GUTTER PER CITY OF SAN BERNARDINO - PUBLIC WORKS DEPT. - STD. DWG. 200 (TYPE "C")
2. CONSTRUCT 36" RIBBON GUTTER PER CITY OF SAN BERNARDINO - PUBLIC WORKS DEPT. - MODIFIED STD. DWG. 201
3. CONSTRUCT SIDEWALK PER CITY OF SAN BERNARDINO - PUBLIC WORKS DEPT. - STD. DWG. 202
4. CONSTRUCT 18" WIDE RES. D/W PER CITY OF SAN BERNARDINO - PUBLIC WORKS DEPT. - MODIFIED (6" THK.) STD. DWG. 203
5. CONSTRUCT VARIABLE HEIGHT CURB ONLY PER CITY OF SAN BERNARDINO - PUBLIC WORKS DEPT. - MODIFIED STD. DWG. 200, TYPE "A"
6. INSTALL 5" CONCRETE (4000 PSI - COMPRESSIVE STRENGTH) CONTRACTOR SHALL PROVIDE JOINT AND JOINT SEAL SUBMITTAL FOR ENGINEER'S APPROVAL
7. INSTALL 4" CONCRETE (3000 PSI - COMPRESSIVE STRENGTH) CONTRACTOR SHALL PROVIDE JOINT AND JOINT SEAL SUBMITTAL FOR ENGINEER'S APPROVAL
8. INSTALL 3" A.C. PAVEMENT OVER 4" CLASS II BASE
9. CONSTRUCT CONCRETE ENCASEMENT 1/4" BARS @ 12" O.C. EACH WAY ABOVE ROUND AND RECTANGULAR DRAIN PIPES (SEE DETAIL ABOVE)
10. CONSTRUCT 3" KNEE WALL (SEE LANDSCAPE PLANS FOR COLOR AND FINISH)
11. INSTALL H.C. SIGNAGE PER DETAILS, SHT. 11
12. INSTALL TRUNCATED DOMES
13. CONSTRUCT HC RAMP AND RAILING PER DETAILS, SHT. 11

NOTES:

REFER TO TRENCH & BEDDING DETAIL PER CITY OF SAN BERNARDINO - PUBLIC WORKS DEPT. - STD. DWG. 306

SEE SHEET 10 OF 10 FOR BOUNDARY AND INTERIOR SECTIONS

E 1800035
LD 1800005

Underground Service Alert

Call: TOLL FREE
1-800-422-4133

TWO WORKING DAYS BEFORE YOU DIG

BENCHMARK:
B.M. NO. B5-6 (NAV 88)
LOCATED 82.0' SOUTH AND 33.5' WEST OF C/L
INTERSECTION OF HOLLY VISTA AVENUE AND GOLDEN
AVENUE, 5.5' SOUTH OF POWER POLE NO. 1883881E
ELEV. 1228.310

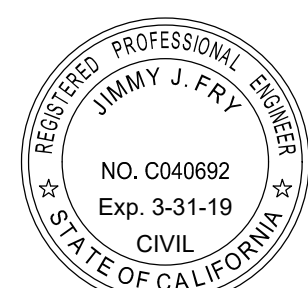
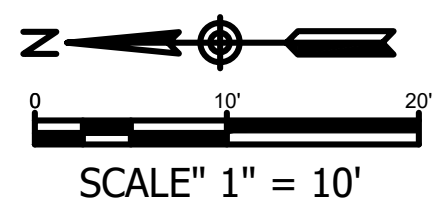

Ludwig Engineering
ASSOCIATES, INC.

Civil Engineering - Surveying - Planning

100 East Third Street
San Bernardino, CA 92410
Phone: 909-894-6217
Fax: 909-894-6218

15252 McCulloch Blvd., Ste. 8
Van Nuys, CA 91411
Phone: 760-761-7976
Fax: 760-761-6272

MARK	REVISIONS	BY	APPR.	DATE
BENCH MARK:				

APPROVED	2018
SENIOR CIVIL ENGINEER REGISTERED CIVIL ENGINEER NO.	
DRAWN BY: MTD	
CHECKED BY: FJW	
RECOMMENDED BY:	

CITY OF SAN BERNARDINO
DEVELOPMENT SERVICES - PUBLIC WORKS/ENGINEERING

GRADING PLAN
FOR
GOLDEN APARTMENTS

CLIENT: GOLDEN APARTMENTS SAN BERNARDINO, LP
PROJECT NO. SB-1113

FOR CITY USE ONLY: FILE NO. W.O. NO.

DRAWING NO.
13205

SHEET 3 OF 8 SHEETS

GOLDEN AVENUE

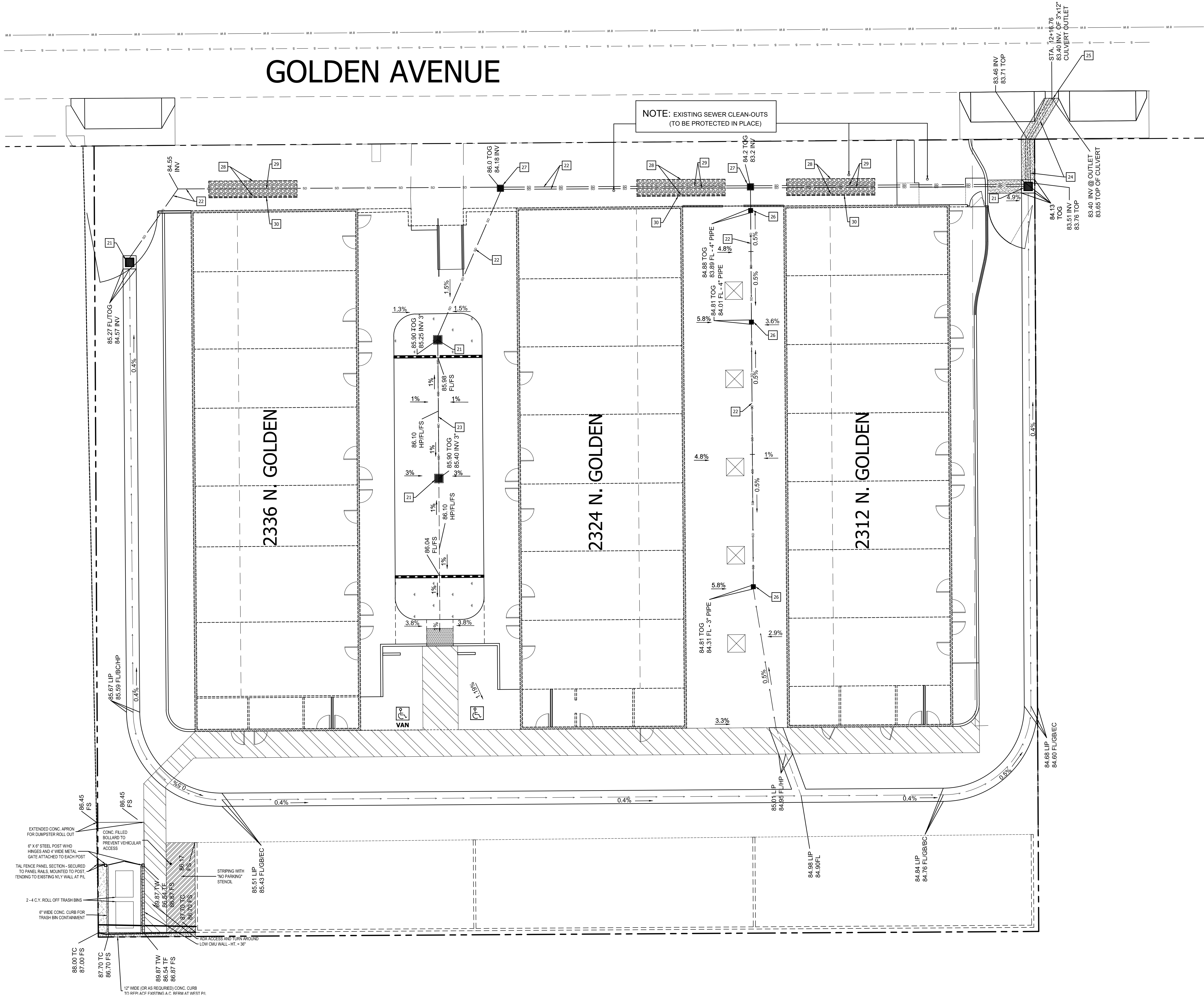

CONSTRUCTION NOTES:

- 21 INSTALL BROOKS BASIN 24-24 (OR EQUAL) W/TRAFFIC RATED GRATE
- 22 INSTALL 4" DRAIN PIPE AT 0.5% MIN.
- 23 INSTALL 3" DRAIN PIPE AT 0.5% MIN.
- 24 INSTALL 3" x 12" CAST IRON RECTANGULAR PIPE/PARKWAY CULVERT PER MODIFIED CITY OF SAN BERNARDINO DEPT. OF PUBLIC WORKS, STANDARD PLAN NO. 401
- 25 CONSTRUCT CURB FACE OUTLET FOR 3" X 12" CAST IRON PARKWAY DRAIN PER MODIFIED CITY OF SAN BERNARDINO DEPARTMENT OF PUBLIC WORKS STD. PLAN 401
- 26 INSTALL 12" NDS CATCH BASIN (OR EQUAL)
- 27 INSTALL 18" NDS CATCH BASIN (OR EQUAL)
- 28 INSTALL GRAVEL FILLED INFILTRATION TRENCH (L=20', W=5', D=3') 105 CU.FT. STORAGE
- 29 INSTALL 4" PERFORATED DRAIN PIPE AT 0.5% MIN. THROUGH LENGTH OF INFILTRATION TRENCH
- 30 INSTALL IMPERMEABLE LINER ON WEST SIDEWALL OF INFILTRATION TRENCH

E 1800035
LD 1800005

Underground Service Alert



Call: TOLL FREE
1-800
422-4133

TWO WORKING DAYS BEFORE YOU DIG

BENCHMARK:

B.M. NO. B5-6 (NAV 88)

LOCATED 82.0' SOUTH AND 33.5' WEST OF C/L
INTERSECTION OF HOLLY VISTA AVENUE AND GOLDEN
AVENUE, 5.5' SOUTH OF POWER POLE NO. 1883881E

ELEV. 1228.310

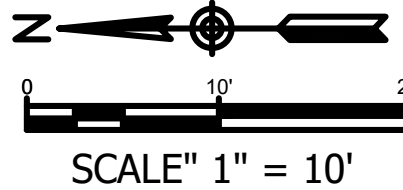

SCALE" 1" = 10'

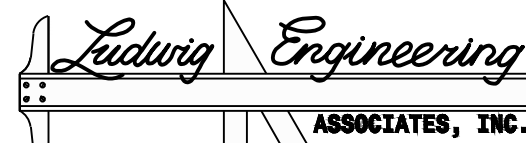
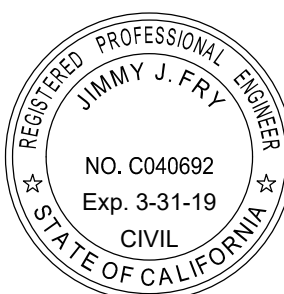

Civil Engineering • Surveying • Planning
100 East Third Street
San Bernardino, CA 92410
Phone: 909-894-6217
Fax: 909-894-6133
15252 Sierra Rd.
Victorville, CA 92392
Phone: 760-952-7976
Fax: 760-241-6272
5800 Hwy. 95, Ste. B
Fort Worth, TX 76103
Phone: 817-768-1857
Fax: 817-768-7086
2126 McCulloch Blvd., Ste. B
Lake Haven City, AZ 86403
Phone: 520-464-6900
Fax: 520-464-6530

MARK	REVISIONS	BY	APPR.	DATE
BENCH MARK:				

APPROVED	2018
SENIOR CIVIL ENGINEER	
REGISTERED CIVIL ENGINEER NO.	
DRAWN BY:	MTD
CHECKED BY:	FJW
RECOMMENDED BY:	

CITY OF SAN BERNARDINO
DEVELOPMENT SERVICES—PUBLIC WORKS/ENGINEERING

DRAINAGE PLAN

FOR

GOLDEN APARTMENTS

CLIENT:
GOLDEN APARTMENTS SAN BERNARDINO, LP

PROJECT NO. SB-1113

FOR CITY USE ONLY: FILE NO.

W.O. NO.

DRAWING
NO.

13205

SHEET 4 OF

8 SHEETS

E. ORCHID DRIVE

GOLDEN AVENUE

- CONSTRUCTION NOTES:
- 41 CONNECT TO EXISTING 8" WATERMAIN W/6" HOT-TAP FOR FIRE PROTECTION SYSTEM PER SBMWD STD. W3.5A AND W3.7
 - 42 INSTALL 4" PIV/FDC PER SBMWD STD. W4.3
 - 43 INSTALL DOUBLE DETECTOR CHECK VALVE PER SBMWD STD. W1.14
 - 44 INSTALL 6" FIRE PROTECTION LINE - (SCH. 80, CLASS 200)
 - 45 INSTALL 6" TEE
 - 46 INSTALL 6" 90° BEND
 - 47 INSTALL THRUST BLOCK PER SBMWD STD. W6.4A
 - 48 INSTALL 6"X4" REDUCER
 - 49 SAWCUT AND TRENCH FOR UTILITY CONNECTION PER CITY OF SAN BERNARDINO DEPT. OF PUBLIC WORKS, STD. PLAN NO. 306
 - 50 CONNECT TO EXISTING 8" WATERMAIN W/6" HOT-TAP FOR FIRE HYDRANT PER SBMWD STD. W3.5A AND W3.7
 - 51 INSTALL FIRE HYDRANT PER SBMWD STD. W2.1 AND W2.2
 - 52 INSTALL "KNOX BOX" (KEY BOX) FOR EMERGENCY VEHICLE ACCESS.

EXISTING SCREEN AND/OR
RETAINING WALL (TO REMAIN)

2336 N. GOLDEN

2324 N. GOLDEN

2312 N. GOLDEN

EXISTING SCREEN AND/OR
RETAINING WALL (TO REMAIN)

EXISTING COVERED PARKING
CARPORTS (TO REMAIN)

EXISTING SCREEN AND/OR
RETAINING WALL (TO REMAIN)

Underground Service Alert



Call: TOLL FREE
1-800
422-4133

BENCHMARK:

B.M. NO. B5-6 (NAV 88)

LOCATED 82.0' SOUTH AND 33.5' WEST OF C/L
INTERSECTION OF HOLLY VISTA AVENUE AND GOLDEN
AVENUE, 5.5' SOUTH OF POWER POLE NO. 1883861E

ELEV. 1228.310

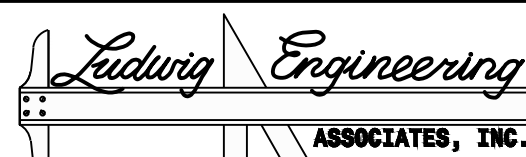
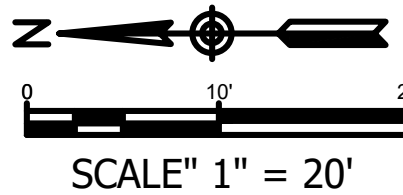

Civil Engineering • Surveying • Planning
109 East Third Street
San Bernardino, CA 92410
Phone: 909-894-6217
Fax: 909-894-6213
15252 Sierra Rd.
Victorville, CA 92392
Phone: 760-952-7976
Fax: 760-241-6272
5800 Hwy. 95, Ste. B
Font Monrovia, CA 91731
Phone: 909-768-1857
Fax: 909-768-7086
2126 McCulloch Blvd., Ste. B
Lake Havasu City, AZ 86403
Phone: 928-654-6500
Fax: 928-654-6530

MARK	REVISIONS	BY	APPR.	DATE
BENCH MARK:				

APPROVED _____ 2018

SENIOR CIVIL ENGINEER
REGISTERED CIVIL ENGINEER NO.

DRAWN BY: MTD

CHECKED BY: FWJ

RECOMMENDED BY:

CITY OF SAN BERNARDINO
DEVELOPMENT SERVICES—PUBLIC WORKS/ENGINEERING

FIRE PROTECTION PLAN

FOR

GOLDEN APARTMENTS

CLIENT:
GOLDEN APARTMENTS SAN BERNARDINO, LP

PROJECT NO. SB-1113

FOR CITY USE ONLY: FILE NO.

DRAWING
NO.

13205

SHEET 5 OF

8 SHEETS

W.O. NO.

